

# NORTH TOWN

## North Town Centre - Retail

137 Avenue NW, Edmonton, AB

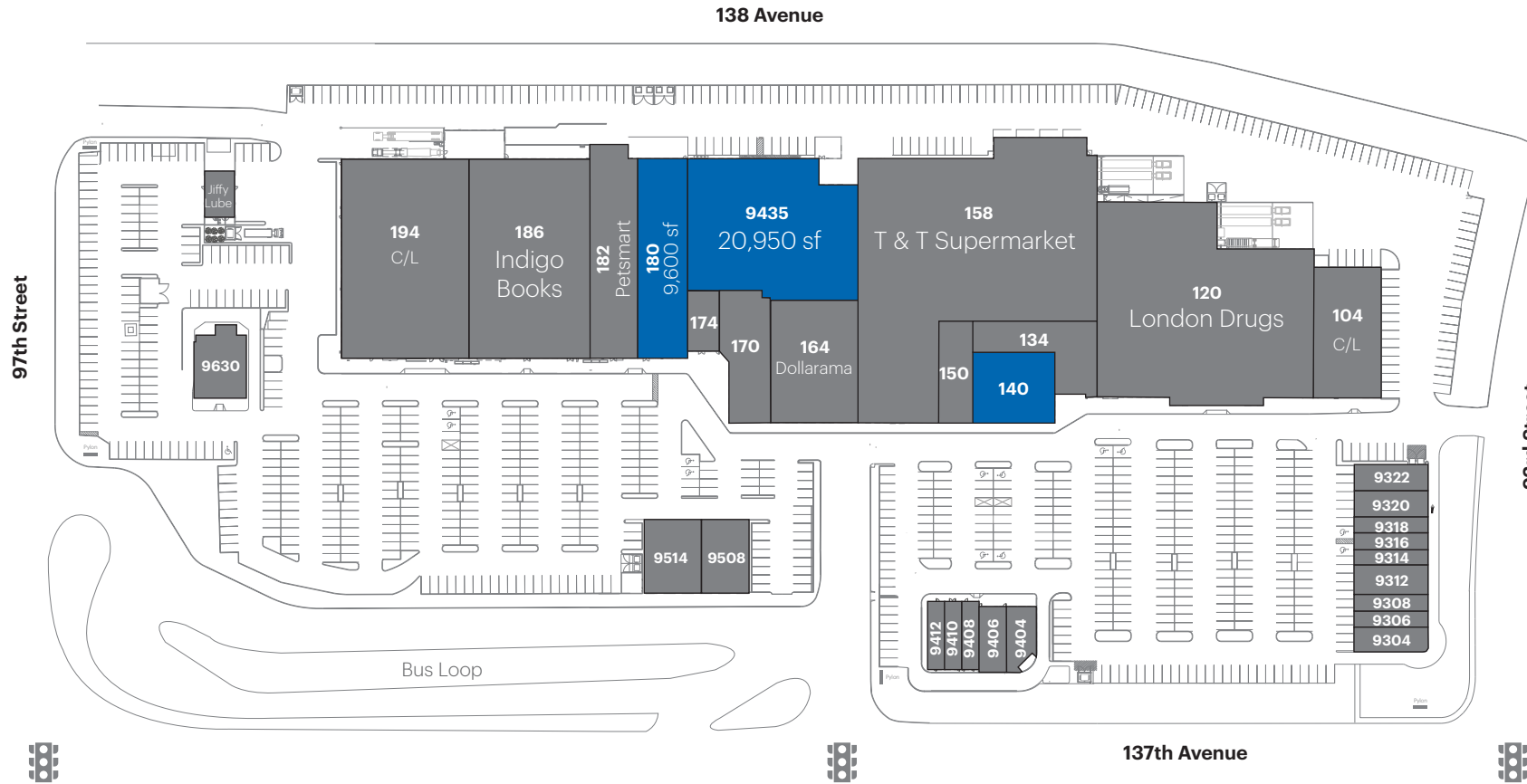
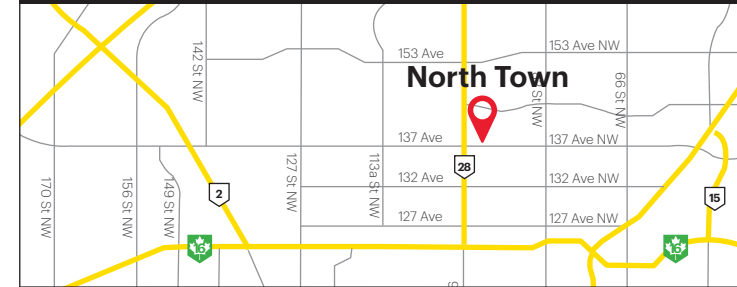

Unit #	Sq.ft.	Tenant Name
9304	1,071	Quizno's Subs
9306	1,285	Gia Hair Salon
9308	1,301	Canada Post & Quality Drycleaning
9312	1,357	Advanced Respiratory Care
9314	1,032	Seoul Fried Chicken
9316	1,029	Mamma Mia
9318	1,051	Freshii
9320	1,577	Jerusalem Shawarma
9322	1,592	Edo Japan
9404	1,696	Blenz Coffee
9406	1,843	Mucho Burrito
9408	879	King Cuts Barbershop
9410	1,033	Fresh Bakery
9412	1,060	Pizza Palace
9435	20,950	Available
104 - 9450	8,103	Conditionally Leased
120 - 9450	36,115	London Drugs
134 - 9450	4,718	Canada Diagnostic Centre
140 - 9450	4,496	Available
150 - 9450	3,283	Pearle Vision
158 - 9450	47,496	T&T Supermarket
164 - 9450	10,292	Dollarama
170 - 9450	5,015	CIBC
174 - 9450	1,885	CDI/ Reeves College
180 - 9450	9,600	Available
182 - 9450	8,779	Petsmart
186 - 9450	19,485	Indigo Books
194 - 9450	24,989	Conditionally Leased
9508	2,813	Boardom
9514	3,419	Mr. Big & Tall
9630	6,000	Wendy's Restaurant
13731 97 St NW	1,635	Jiffy Lube



Leased
  Available
  Common Areas
  Separate Ownership

This is a representation for leasing purposes only and should not be used for measurements and co-tenancy of any kind. This drawing is not to scale.

**Anthem**  
anthemproperties.com

**Bob Tattle**

btattle@anthemproperties.com  
604 488 3638

**Jeff Pockett**

jpockett@anthemproperties.com  
604 638 4387



# North Town Centre - Office

9450 137 Avenue NW, Edmonton, AB

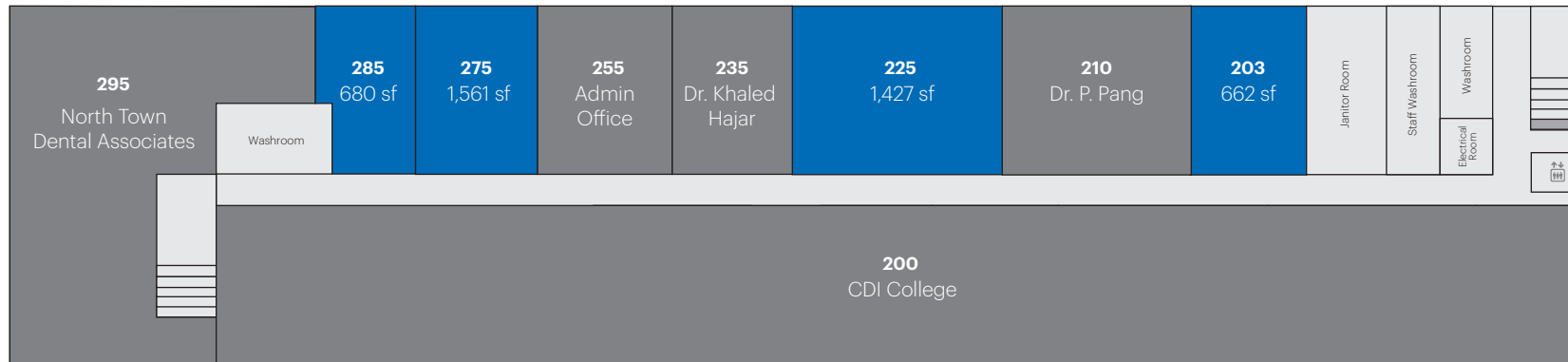
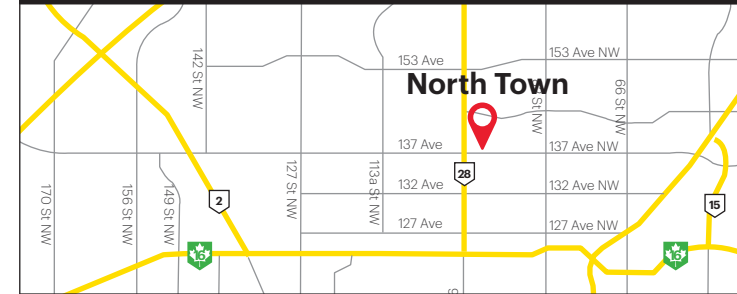

Unit #	Sq.ft.	Tenant Name
200	8,649	CDI College
203	662	Available
210	1,215	Dr. P. Pang
225	1,427	Available
235	1,115	Dr. Khaled Hajar - General Praictioner/Family
255	1,136	Admin Office
275	1,561	Available
285	680	Available
295	3,597	North Town Dental Associates



Leased
  Available
  Common Areas
  Separate Ownership

This is a representation for leasing purposes only and should not be used for measurements and co-tenancy of any kind. This drawing is not to scale.



**Bob Tattle**

btattle@anthemproperties.com  
604 488 3638

**Jeff Pockett**

jpockett@anthemproperties.com  
604 638 4387